

Medium Size Chip-On Receptacle

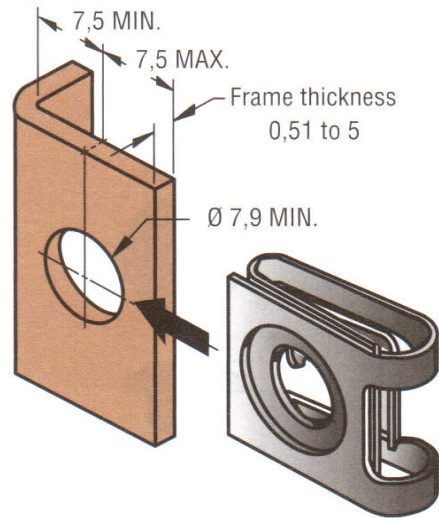
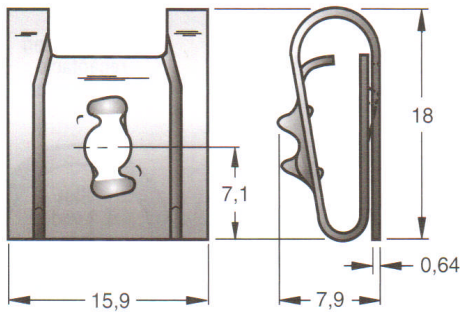

Part Number

Type 1064 (Steel)	<b>82-47-113-15</b>
Type 17-7PH steel (Stainless)	<b>82-47-113-20</b>

Material:-

- 1064 steel, zinc immersion coating or 17-7PH stainless steel, passivated
- can be installed by hand, screwdriver or installation tool

► For installation tool order  
Part No: 29-82-101-10



Medium Size Chip-On Receptacle Installation Tool

Installation Tool



P/No: 29-82-101-10

Adjustment Formula

To enter Stud Selection Table determine your Total Material Thickness by calculating.

Figure 1

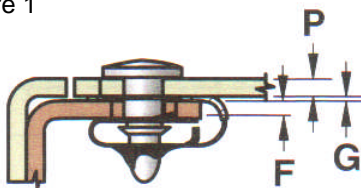

$P + F + 1.40 (.55")$  (constant) when G is 0.64 (.25")

Figure 2

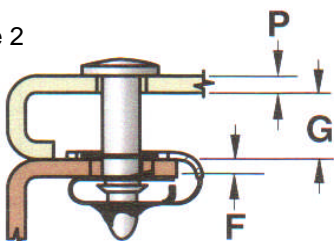

$P + F + G + 0.76 (.030")$  (constant) when G is 0.65 (.26") or greater.

Installation

By hand

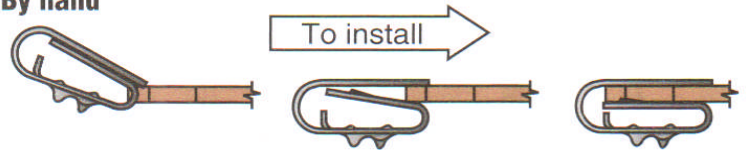

With tool

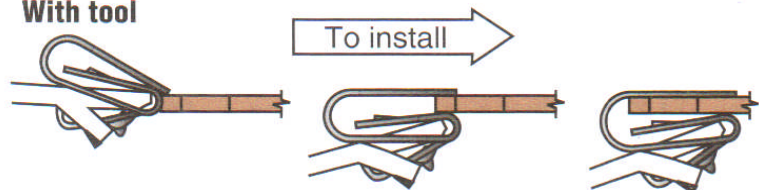

With screwdriver

